



# IGS-182GP

**Industrial 10 port unmanaged Ethernet switch with 8x10/100/1000Base-T(X) with 2x100/1000Base-X SFP port**

## Features

- Supports 8 ports 10/100/1000 Base-T(X)
- Support 2 ports 100/1000Base-X
- Supports auto-negotiation and auto-MDI/MDI-X
- Supports store and forward transmission
- Supports flow control
- Compact size for easily installation
- Rigid IP-30 housing design
- DIN-Rail and wall mounting enabled



## Introduction

IGS-182GP is unmanaged Ethernet switch with 8x10/100/1000Base-T(X) with 2x100/1000Base-X ports. With very compact size of housing, you can install IGS-182GP easily. In addition, IGS-182GP is with rigid IP-30 housing design and can operate under harsh environment. The extended operating temperature range from -40 °C to 75°C is ready and can satisfy most requirement of operation.

## Dimension

Unit =mm (Tolerance ±0.5mm)

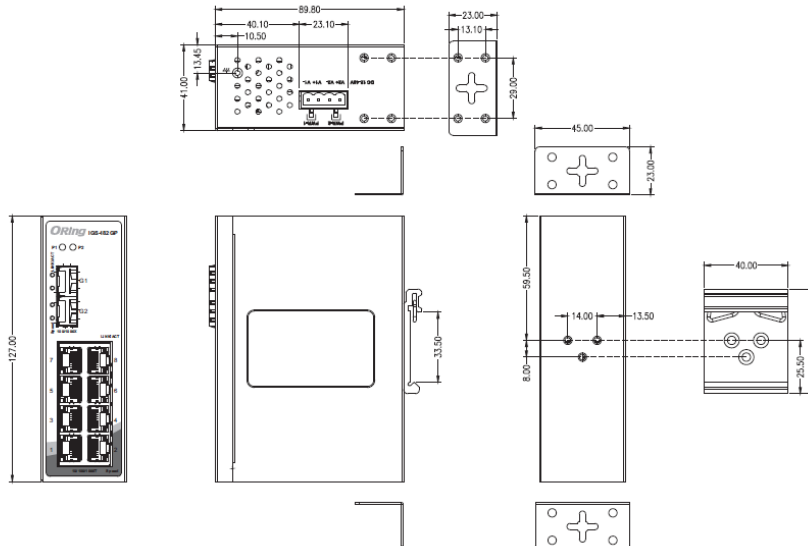

## Specifications

| ORing Switch Model                                   | IGS-182GP  |
|--|--|
| <b>Physical Ports</b>                                |  |
| 10/100/1000 Base-T(X) Ports in RJ45<br>Auto MDI/MDIX | 8  |
| 100/1000Base-X ports                                 | 2  |
| <b>Technology</b>                                    |  |
| Ethernet Standards                                   | IEEE 802.3 for 10Base-T<br>IEEE 802.3u for 100Base-TX and 100Base-FX<br>IEEE 802.3ab for 1000Base-T<br>IEEE 802.3z for 1000Base-X<br>IEEE 802.3x for Flow control  |
| MAC Table  | 4K   |
| Processing   | Store-and-Forward  |
| Switch Latency                                       | <7us   |
| Switch Bandwidth                                     | 20G bps  |
| Packet buffer size                                   | 1.5M bits  |
| Jumbo Frame  | 9216 Bytes   |
| <b>LED indicators</b>                                |  |
| Power Indicator                                      | Green for PWR1, PWR2   |
| 10/100/1000Base-T(X) RJ45 Port<br>Indicator          | Upper for Link/Act indicator, Green for port Link/Act.<br>Lower for speed indicator, Green for 1000Mbps, Amber for 100Mbps, OFF for 10Mbps   |
| 100/1000Base-X SFP Port Indicator                    | Upper for Link/Act indicator, Green for port Link/Act.<br>Green for 1000Mbps, Amber for 100Mbps  |
| <b>Power</b>   |  |
| Input Power  | Dual 12~48 VDC voltage power input on 4-pin terminal block   |
| Power Consumption (Typ.)                             | <5Watts,12-48VDC: 0.41A-0.11A  |
| Overload Current Protection                          | Present  |
| Reverse Polarity Protection                          | Present  |
| <b>Physical Characteristic</b>                       |  |
| Enclosure  | IP-30, Metal   |
| Dimension (W x D x H)                                | 41 (W) x 89.8 (D) x 127 (H)mm  |
| Weight (g)   | 400g   |
| <b>Environmental</b>                                 |  |
| Storage Temperature                                  | -40 to 85°C (-40 to 185°F)   |
| Operating Temperature                                | -40 to 75°C (-40 to 167°F)   |
| Operating Humidity                                   | 5% to 95% Non-condensing   |
| <b>Regulatory approvals</b>                          |  |
| EMC  | CE EMC (EN 55024, EN 55032), FCC Part 15 B   |
| EMI  | EN 55032, CISPR32, EN 61000-3-2, EN 61000-3-3, FCC Part 15 B class A   |
| EMS  | EN 55024 (IEC/EN 61000-4-2 (ESD: Contact 6KV, Air 8KV), IEC/EN 61000-4-3 (RS: 3V), IEC/EN 61000-4-4 (EFT Power 2KV, Signal 2KV), IEC/EN 61000-4-5 (Surge: Power 1KV, RJ45 1KV), IEC/EN 61000-4-6 (CS: 3V), IEC/EN 61000-4-8(PFMF), IEC/EN 61000-4-11 (DIP) |
| Shock  | IEC60068-2-27  |
| Free Fall  | IEC60068-2-31  |
| Vibration  | IEC60068-2-6   |
| Safety   | UL61010-1;UL61010-2-201  |
| MTBF   | 1056,516 hours   |
| Warranty   | 5 years  |

## Ordering Information

**IGS-1ABGP**

| Code Definition | 10/100/1000Base-T(X) Port Number | 100/1000Base-X SFP Port Number |
|-----------------|----------------------------------|--------------------------------|
| Option          | - 8: 8 ports                     | - 2: 2 port                    |

| Available Model | Model Name       | Description  |
|-----------------|------------------|--|
|                 | <b>IGS-182GP</b> | Industrial 10-port unmanaged Ethernet switch with 8x10/100/1000Base-T(X) with 2x100/1000Base-X SFP ports |

## Packing List

- **IGS-182GP x 1**
- **Quick Installation Guide x 1**
- **Din-Rail Kit x 1**
- **Wall-mount Kit x 1**

## Optional Accessories

- **SDR/DRP Series DIN-Rail power supply**
- **SFP100 series : 100Mbps SFP optical transceiver**
- **SFP 1G series : 1Gbps SFP optical transceiver**